

# PR-52 Replacement valve for pump cartridge

Prior to Jan. 2007

10 CFM

Remove Cover and Splash Guard.  
Wipe inside cover surfaces and cartridge clean.

**DO NOT DISTURB  
CARTRIDGE ASSEMBLY BOLTS OR SETTING SCREWS**

Use 5/32" Allen wrench for socket headscrews

## Top View

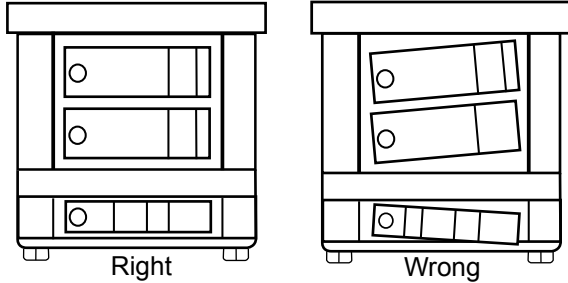

Center Valves between side surfaces



J/B Industries Inc. Aurora, IL 60507 U.S.A.  
Technical Service: 800.323.0811  
E-mail: sales@jbind.com  
Website: www.jbind.com  
©2007 J/B Industries, Inc. Printed in the U.S.A.

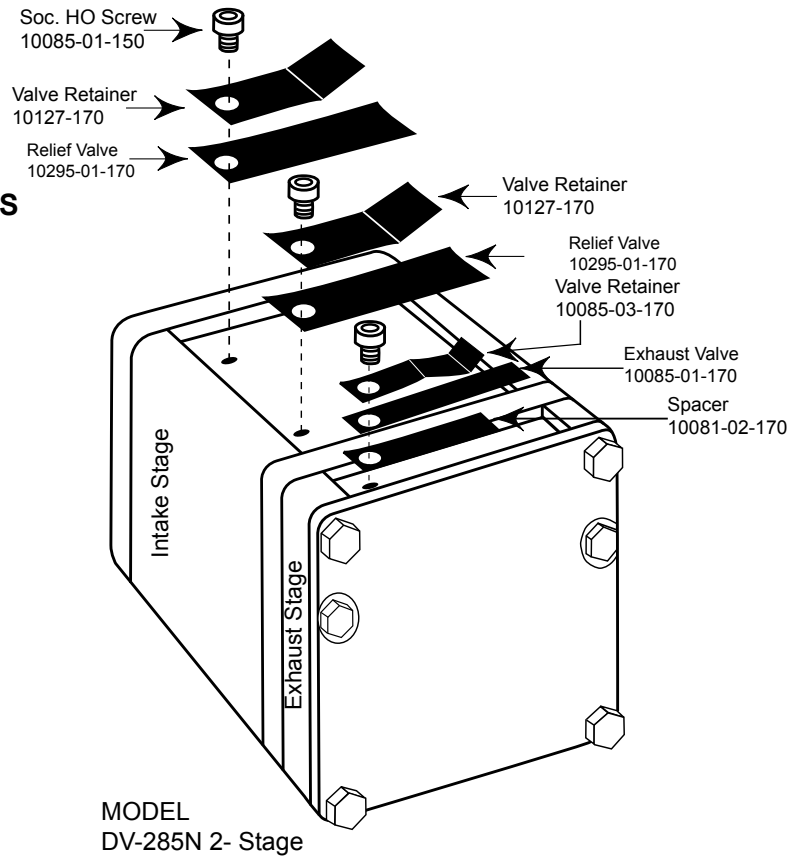

Form No. 10432-308

# PR-52 Replacement valve for pump cartridge

Prior to Jan. 2007

10 CFM

Remove Cover and Splash Guard.  
Wipe inside cover surfaces and cartridge clean.

**DO NOT DISTURB  
CARTRIDGE ASSEMBLY BOLTS OR SETTING SCREWS**

Use 5/32" Allen wrench for socket headscrews

## Top View

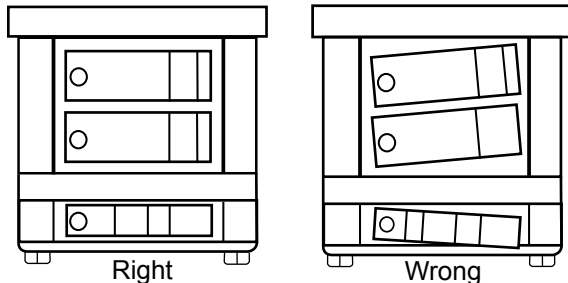

Center Valves between side surfaces



J/B Industries Inc. Aurora, IL 60507 U.S.A.  
Technical Service: 800.323.0811  
E-mail: sales@jbind.com  
Website: www.jbind.com  
©2007 J/B Industries, Inc. Printed in the U.S.A.

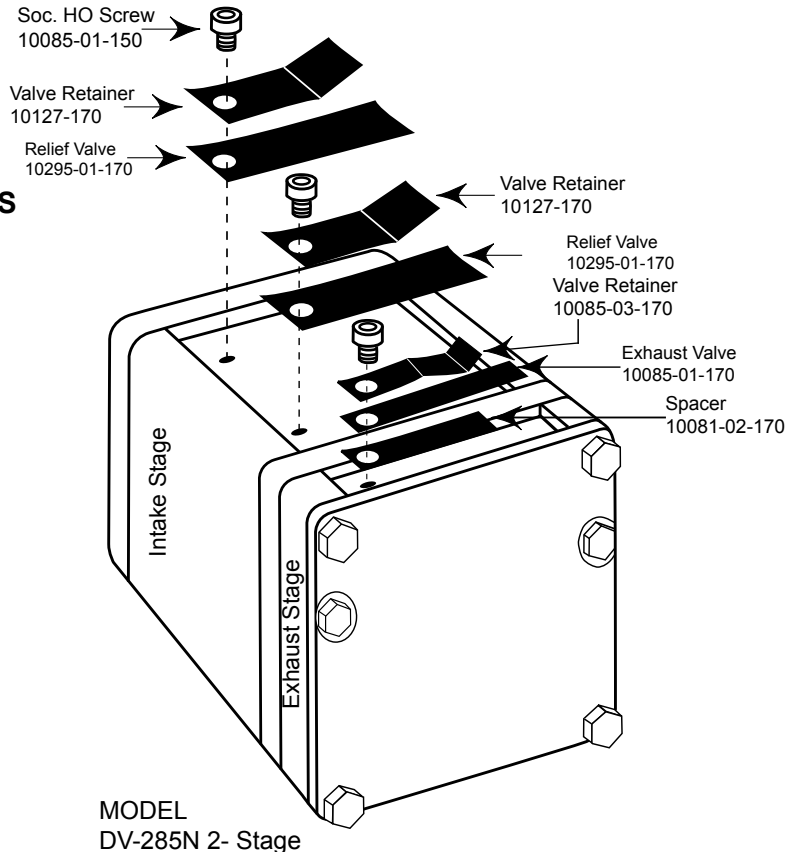

Form No. 10432-308