



INSTALLATION INSTRUCTIONS

STUB TUBE, SADDLE MOUNT AND NPT SEATS

1. CoreMax Cores should remain in protective packaging until assembly is required to ensure cleanliness and eliminate damage.



Stub Seat

Saddle Seat

NPT Seat

3. Make sure there is no contamination in the I.D. of the Seat, especially the o-ring groove.

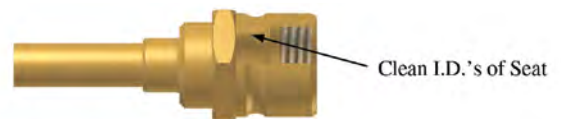

O-Ring Groove

Stub Seat

CoreMax Core

4. Make sure the o-ring on the Core is free of contamination and foreign particulates. Lightly lubricate with compatible refrigerant oil.

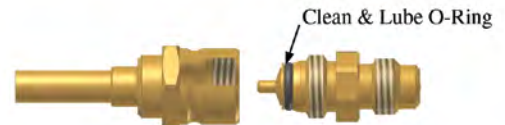

2. Braze SEAT ONLY onto tube or valve block before installing/threading Core into Seat.



Tube brazed to Seat

5. Thread Core into Seat and torque clockwise to 8 ft/lbs.



For more information visit fastest.com/products



FOLLOW US!
f in y o



JB INDUSTRIES | **FASTEST[™]**

Manufactured by FasTest Inc. in partnership with JB Industries.



INSTALLATION INSTRUCTIONS

NUT STYLE PANEL MOUNT ACCESS VALVES

1. CoreMax Cores should remain in protective packaging until assembly is required to ensure cleanliness and eliminate damage.

2. Insert Seat through hole in panel and thread Nut onto Seat.

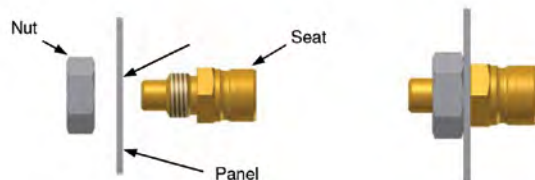

3. Braze SEAT ONLY onto Tube or valve block before installing/ threading Core into Seat.

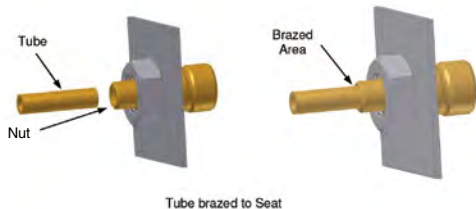

4. Make sure there is no contamination in the I.D. of seat, especially the o-ring groove.

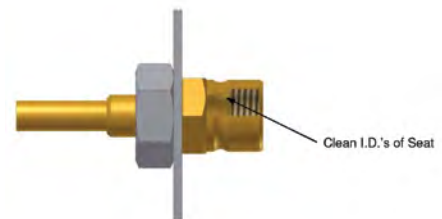

5. Inspect the Core to ensure the o-ring is free of contamination and foreign particulates. Lightly lubricate with compatible refrigerant oil.

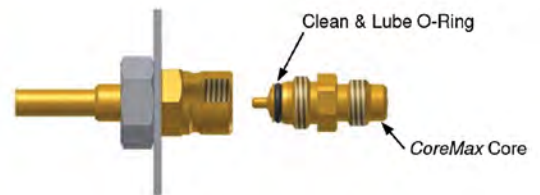

6. Thread Core into Seat and torque clockwise to 8 ft/lbs.

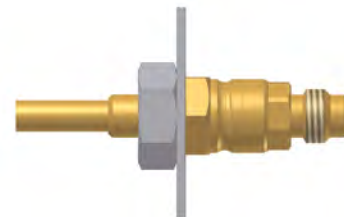

For more information visit fastest.com/products



FOLLOW US!
f in y o



JB INDUSTRIES | **FASTEST[™]**

Manufactured by FasTest Inc. in partnership with JB Industries.



INSTALLATION INSTRUCTIONS

CLIP STYLE PANEL MOUNT ACCESS VALVES

For more information visit fastest.com/products

1. Cores should remain in protective packaging until assembly is required to ensure cleanliness and eliminate damage.

2. Push the self-locking Backup Clip (retaining ring) onto Seat.

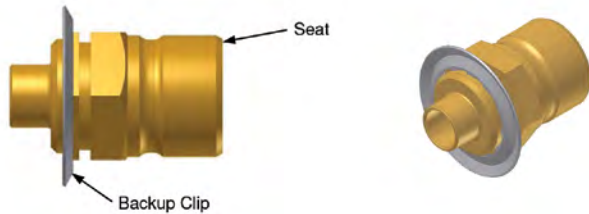

3. Braze SEAT ONLY onto Tube or valve block before installing or threading Core into Seat.

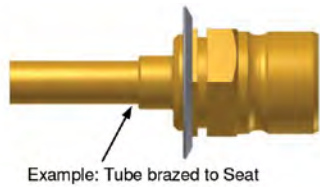

4. Install seat thru hole in panel to the Backup Clip. Hole in panel must be larger than the hex corners.

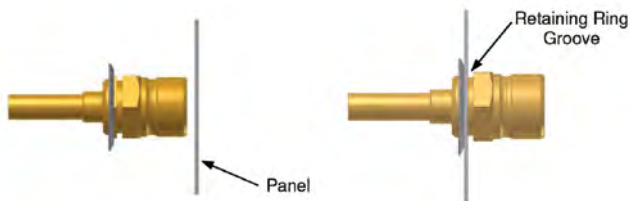

5. Install Retaining Ring into groove on the Seat.

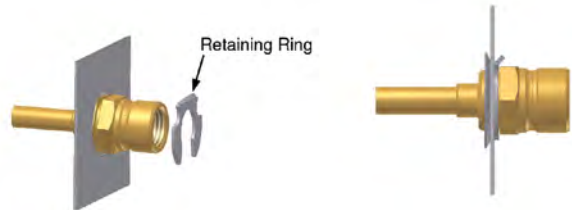

6. Make sure the I.D. of Seat is clean, and then inspect the Core to ensure the o-ring is free of contamination and foreign particulates. Lightly lubricate with compatible refrigerant oil.



7. Thread Core into Seat and torque clockwise to 8 ft/lbs.

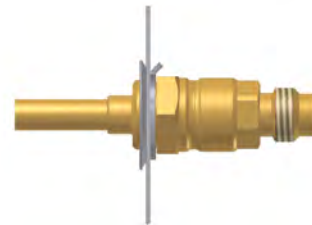

For more information visit fastest.com/products



FOLLOW US!
f in y @



JB INDUSTRIES | **FASTEST**
Manufactured by FasTest Inc. in partnership with JB Industries.